

# Asahi Baseball Association

## Restart Safety Plan

Baseball Training at Richmond Olympic Oval

October 14, 2020

---

---

### Table of Contents

Participant Safety .....	2
Coaches' Safety .....	2
Training Details .....	3
Schedule .....	3

---

## Participant Safety

- Parents will be provided the "Asahi Return to Play Guidelines" (Appendix A).
- Participants have to stay at home if they feel ill.
- Participants need to report to the coaches if they feel sick after training sessions.
- Any participants who have been outside of Canada within 14 days will not be allowed to participate in the training sessions.
- Participants will sanitizes hands before and after training sessions. Sanitizer will be provided on the courts.
- No parents will be allowed in the building unless they are parent coaches.
- Participants will enter and exit the building through the door assigned to the Asahi Group on the 2nd level at the southwest corner of the building described in the "Asahi Return to Play Guidelines".
- Participants need to check-in just outside of the Asahi designated door no earlier than 15 minutes prior to their scheduled sessions. Participants shall line up socially distanced while checking in. Parent volunteers or coaches will be responsible to check-in players for the purpose of contact tracing and screening of participants for possible COVID-19 exposure.
- Participants will wear a mask in the common area spaces of the building and will wear a mask when going between the batting cage and the courts.
- Participants will have a designated location for their equipment in the courts that will be separated 2 metres apart.
- All activity will occur in the designated courts and cage. No activity is to occur outside of these areas.
- Participants must have their own equipment. No sharing of equipment will be allowed.
- Equipment will be sanitized after every session.
- Parents must leave contact information in case of an emergency.
- Maximim participants will be 20 for each training session. The participants will be physically distanced in the courts and batting cages.

---

## Coaches' Safety

- Minimize the number of coaches to 4 to 6 coaches per session so that there will no more than 25 persons at each training session.
- Coaches have to sanitize hands before and after the training.
- Coaches will wear masks during the training.
- Coaches will not attend the sessions if they are ill.
- Coaches will physically distance 2 metres from the players and other coaches.

## Training Details

- Asahi will provide the sanitizers during the training sessions.
  - Limit the number of persons in the respective training sessions to 26 people including participant, coaches and volunteers .
  - Training session is a maximum of 2 hours.
  - There will be a 15 minute transition period between groups to minimize contact with the next group and th allow time to sanitize the equipment and training areas.
  - No touching and shaking hands between participants/ parents/ coaches.
  - No sharing of gloves, catcher's equipment, batting helmets, and bats.
- 

## Training Schedule

**Sunday, October 18, 25, November 1, 8, 15, 22, 29**

Group 1	8:30 to 10:00 AM (Tentative)
Group 2	10:15 AM to 12:15 PM
Group 3	12:30 to 2:30 PM
Group 4	2:45 to 4:45 PM
Group 5	5:00 to 7:00 PM



# Return to Play Guidelines

The following rules are the guidelines for return to play at the Oval:

1. Players are to be dropped off at the rear entrance doors no earlier than 15 minutes before your scheduled session. No parents are allowed into the building.
2. Players will be checked in outside the rear doors.
3. Players will be wait while socially distanced outside until the group within the Oval has completed their session.
4. Players will wear a mask inside the common area spaces.
5. Players will have a designated location for their equipment in the courts that will be separated 2 metres apart.
6. All activity will occur in the designated courts and cage. No activity is to occur outside of these areas.
7. Players must have their own equipment. No sharing of equipment will be allowed.
8. Hand sanitizer will be provided on the courts.
9. Players need to wear a mask when going between the batting cage and the courts.
10. Players need to wear a mask when going to the washrooms.
11. Players will exit the building on the backside of the building where they can meet the parents.
12. Equipment will be sanitized after every session.
13. Parents must leave contact information in case of an emergency.

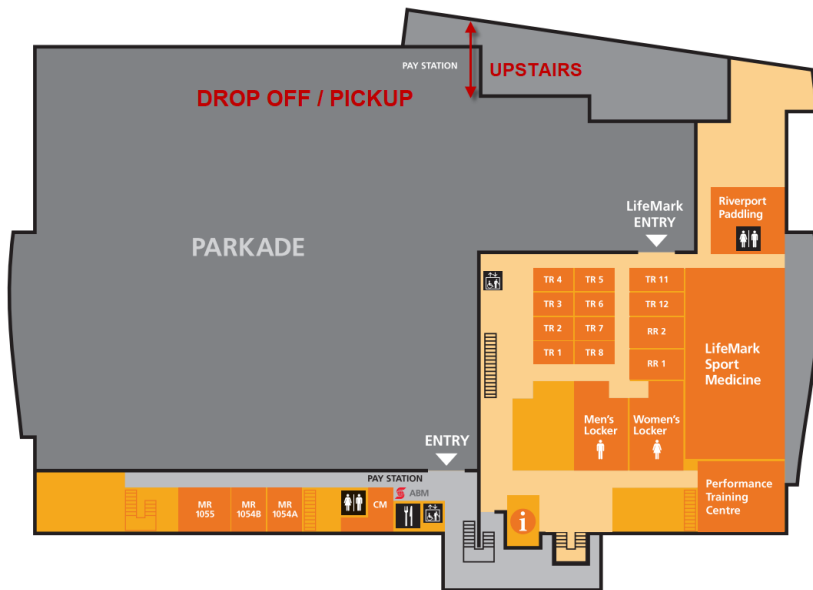

**First Floor (Parkade)**

Drop off player either through the parkade. Go to the rear staircase to reach the second floor.

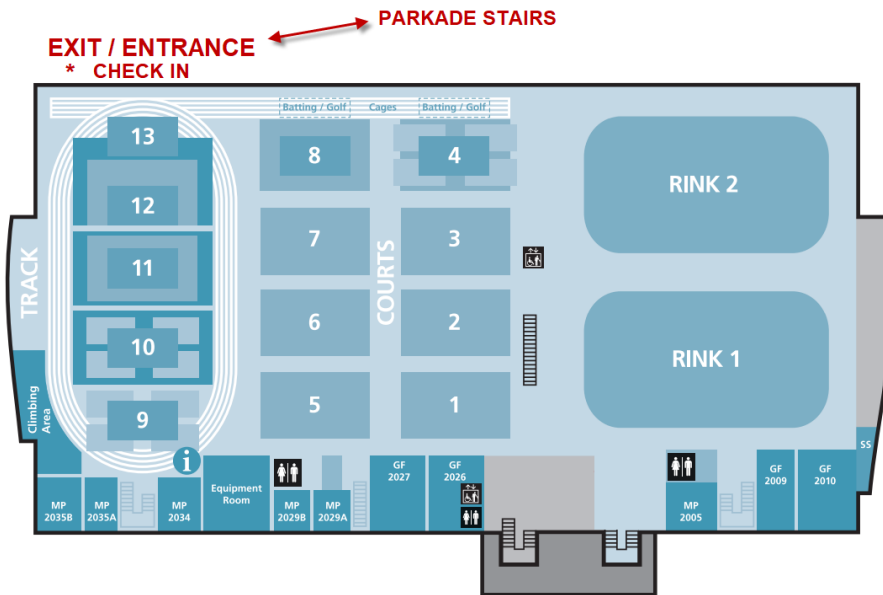

**Second Floor**

The check-in will be outside the rear entrance. Parents can meet there and go down to the parkade. You will need to wait outside until the previous group has completed before you will be allowed in.